



Air Conditioner Treatment

Technical Data Sheet

© Forté 03/18

PRODUCT DESCRIPTION:

When used as directed, Forté Air Conditioner Treatment will effectively neutralise unpleasant odours that are emitted from air conditioning systems that have not been in use for a length of time. These odours are caused by mould and fungi that breeds in the moisture that builds up on the evaporator. Bacteria is released which can affect the health of passengers with flu-like symptoms, commonly known as 'sick car syndrome'.

Forté Air Conditioner Treatment contains an antimicrobial agent that will eliminate the mould and fungi. The cleaning agent is non-solvent based and is not harmful to humans or animals, nor will it affect any components in the ventilation system or materials in the passenger cabin such as wood, leather, plastic or fabric.

The treatment has a dual benefit in that it also deodorises the interior of the vehicle. Not only does it remove the damp musty smell emanating from the ventilation system but it also eliminates animal smells and stale smoke smells from the interior upholstery. The treatment leaves a fresh odour for customer satisfaction.

PRODUCT BENEFITS:

- Destroys bacteria on the evaporator
- Eliminates unpleasant odours emitted from air conditioning systems
- Deodorises the passenger cabin
- Provides a healthier environment for car occupants
- Simple safe application

NOTES:

Check that the ventilation system ducting drain pipe is not blocked; clear if necessary.
 Fragrance will dissipate within 4 - 5 days as doors are opened and closed.
 Any deposits on glove box or windscreen can be wiped clean with a lint-free cloth.
 For further guidance, contact:
 Forté Technical Helpline on 024 7642 1131.

DIRECTIONS FOR USE:

1. Remove particle filters from re-circulation system if fitted.
2. Ensure all windows and doors are closed.
3. Start the engine.
4. Switch on air conditioning system and set to lowest temperature setting.
5. Set the system to recirculate internal air. Do not draw in external air.
6. Set controls to select face level fascia vents and ensure that they are open.
7. Set the fan blower to half speed.
8. Position front passenger seat as far back as it will go.
9. Shake can of treatment well, remove cap and stand can in passenger footwell.
10. Depress trigger into lockdown position (trigger should be facing rear of vehicle).
11. Exit vehicle and close door. Allow vehicle to run and can to discharge for 10 minutes.
12. Set controls to normal setting from recirculate and run vehicle for a further 5 minutes.
13. Turn engine off, remove and dispose of aerosol can appropriately.
14. Open doors and allow vehicle to 'air' for 15 minutes before driving.

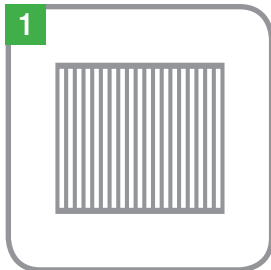

1 Remove particle filter if fitted.

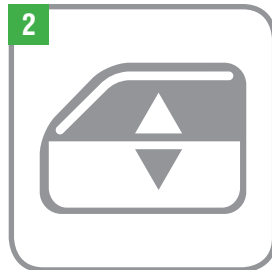

2 Close windows.

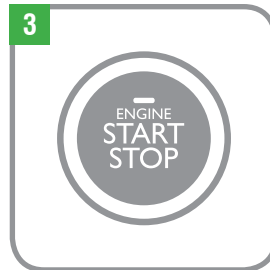

3 Start engine.



4 Switch on A/C and set to lowest temperature setting.

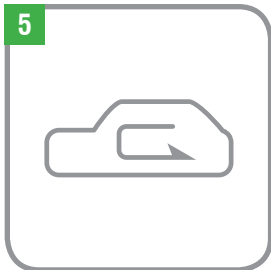

5 Set controls to recirculate.



6 Select face level fascia vents and open.

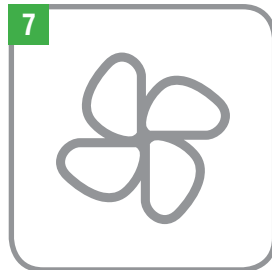

7 Set blower to half speed.



8 Set passenger seat as far back as it goes.



9 Shake can and stand in passenger footwell.



10 Depress trigger.



11 Exit vehicle. Close doors. Leave to run for 10 mins.

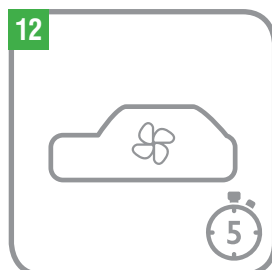

12 Set controls to normal from recirculation. Run for 5 mins.



13 Turn off engine. Remove and dispose of product appropriately.



14 Open doors and allow to air for 15 mins.